

Dear Customer,
Thank you for choosing a Hanna product.
If you need additional technical information, do not hesitate to e-mail us at tech@hannainst.com.
These instruments are in compliance with the **CE** directives.

SPECIFICATIONS

Range/Resolution	
DiST1 (HI96301)	1990ppm / 10ppm
DiST2 (HI96302)	10000ppm / 100ppm
DiST3 (HI96303)	1990 μ S/cm / 10 μ S/cm
DiST4 (HI96304)	19900 μ S/cm / 100 μ S/cm
Accuracy (@20°C)	\pm 2% Full Scale
Calibration	manual, 1 point
Calibration solution	(optional)
DiST1 (HI96301)	HI70032P
DiST2 (HI96302)	HI70038P
DiST3 (HI96303)	HI70031P
DiST4 (HI96304)	HI70039P
Temperature Compensation	
	Automatic, 5 to 50°C (41 to 122°F)
Environment	
	0 to 50°C (32 to 122°F); RH 95% max
Battery type	4 x 1.5V alkaline
Battery life	approx. 150 hours of use
Dimensions	
	150x30x21 mm (5.9x1.2x0.8")
Weight	70 g (2.5 oz.)

ACCESSORIES

HI 70031P	1413 μ S/cm calibration sachet (20 ml, 25 pcs)
HI 70032P	1382 ppm calibration sachet (20 ml, 25 pcs)
HI 70038P	6.44 ppt calibration sachet (20 ml, 25 pcs)
HI 70039P	5000 μ S/cm calibration sachet (20 ml, 25 pcs)

DiST is a registered Trademark of
"Hanna Instruments"

IST96301 12/04

DiST[®] 1 • DiST[®] 2 DiST[®] 3 • DiST[®] 4

**HI 96301 • HI 96302
HI 96303 • HI 96304**

**Pocket-Sized
EC/TDS Meters
with ATC**

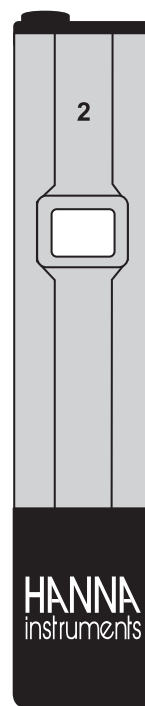

 **HANNA[®]**
instruments
www.hannainst.com

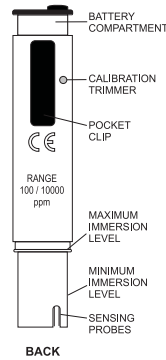
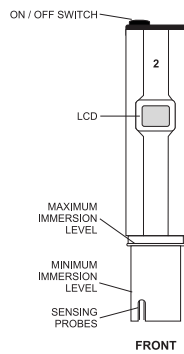

OPERATION

- Remove the protective cap.
- Turn the meter ON sliding the switch on the top.
- Immerse into solution up to the max immersion level without touching the bottom of the beaker.
- Stir gently and wait until the display stabilizes. Readings are automatically compensated for temperature variations.
- The value on the display has to be multiplied by a factor of 10 for **DiST1** & **DiST3** and by a factor of 100 for **DiST2** & **DiST4** (as shown on the upper left corner of the LCD) to give direct reading in ppm or $\mu\text{S}/\text{cm}$.

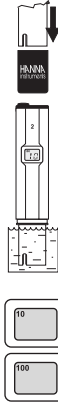

CALIBRATION

- Immerse the tester up to the maximum immersion level in the appropriate calibration solution (see Specifications).
- Allow the reading to stabilize and using a small screwdriver adjust the calibration trimmer to match the solution value. E.g. calibrating **DiST1** with **HI70032P** solution, turn the trimmer to read "138" (x10 = 1380 ppm).

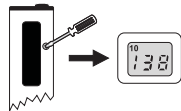

BATTERY REPLACEMENT

When the meter cannot be switched on or the display fades, pull out the battery compartment and replace all four 1.5V batteries, while paying attention to their polarity.

Batteries should only be replaced in a safe area using the battery type specified in this instruction manual.

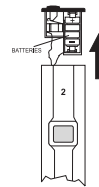

Recommendations for users

Before using these products, make sure that they are entirely suitable for the environment in which they are used. Operation of these instruments in residential areas could cause interference to radio and TV equipment. The pins at the end of the sensor are sensitive to electrostatic discharges. Avoid touching this metal band at all times. Any variation introduced by the user to the supplied equipment may degrade the instrument's EMC performance. To avoid electrical shock, do not use this instrument when voltages at the measurement surface exceed 24 Vac or 60 Vdc. To avoid damage or burns, do not perform any measurement in microwave ovens.

WARRANTY

These meters are guaranteed for six months against defects in workmanship and materials when used for their intended purpose and maintained according to instructions. This warranty is limited to repair or replacement free of charge. Damages due to accident, misuse, tampering or lack of prescribed maintenance are not covered. If service is required, contact the dealer from whom you purchased the instrument. If under warranty, report the model number, date of purchase, serial number and the nature of the failure. If the repair is not covered by the warranty, you will be notified of the charges incurred. If the instrument is to be returned to Hanna Instruments, first obtain a Returned Goods Authorization Number from the Customer Service department and then send it with shipment costs prepaid. When shipping any instrument, make sure it is properly packaged for complete protection.